



INSTALLATION INSTRUCTIONS

Accessory
BODY SIDE MOLDINGS

Application
2015 RLX

Publications No.
BII 51830
Issue Date
JULY 2014

PARTS LIST

Left front molding

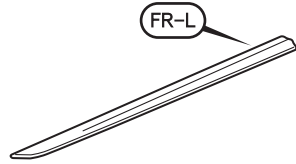

Right front molding

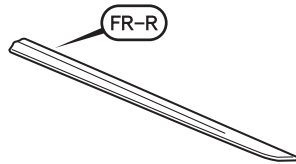

Left rear molding



Right rear molding

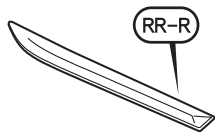

Front template

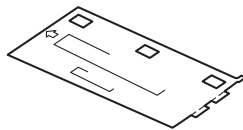

Rear template

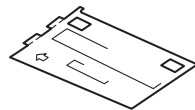

4 Alcohol swabs

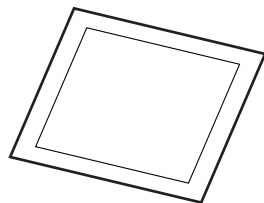

TOOL AND SUPPLIES REQUIRED

Masking tape

Ruler

The following tool is available through the Honda Tool and Equipment Program. On the iN, click on: Service > Service Bay > Tool and Equipment Program, then enter the number under "Search". Or, call 888-424-6857.

- Rubber Roller (T/N MHLE54D)

Illustration of the Body Side Moldings on the Vehicle

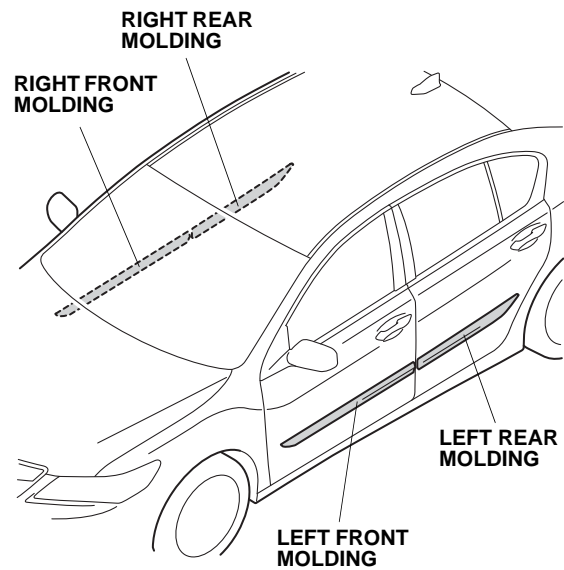

QB22001AJ

INSTALLATION

Client Information: The information in this installation instruction is intended for use only by skilled technicians who have the proper tools, equipment, and training to correctly and safely add equipment to your vehicle. These procedures should not be attempted by “do-it-yourselfers.”

NOTE:

- Be careful not to damage the body paint finish.
- This body side moldings kit should be installed only if the ambient air temperature is 15°C (60°F) or above.
- To allow the adhesive to cure, do not wash the vehicle for 24 hours. Please advise the client.

Installing the Body Side Moldings

1. Using the alcohol swab, thoroughly clean the left front door where the left front molding will attach.

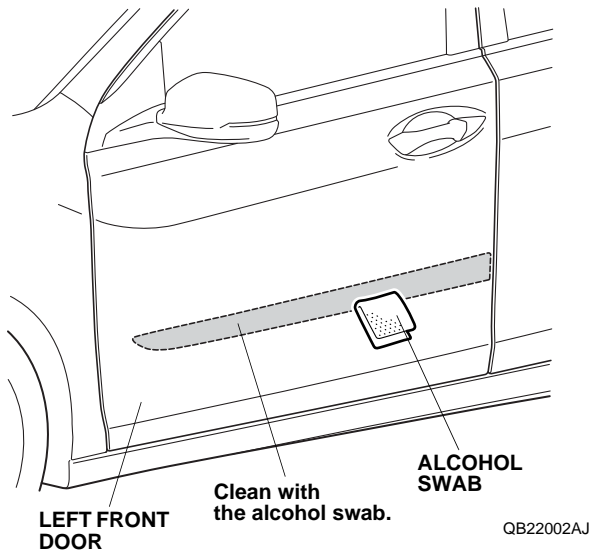

2. Get the front template. Fold the two tabs on the front template in the direction shown, and insert them between the doors.

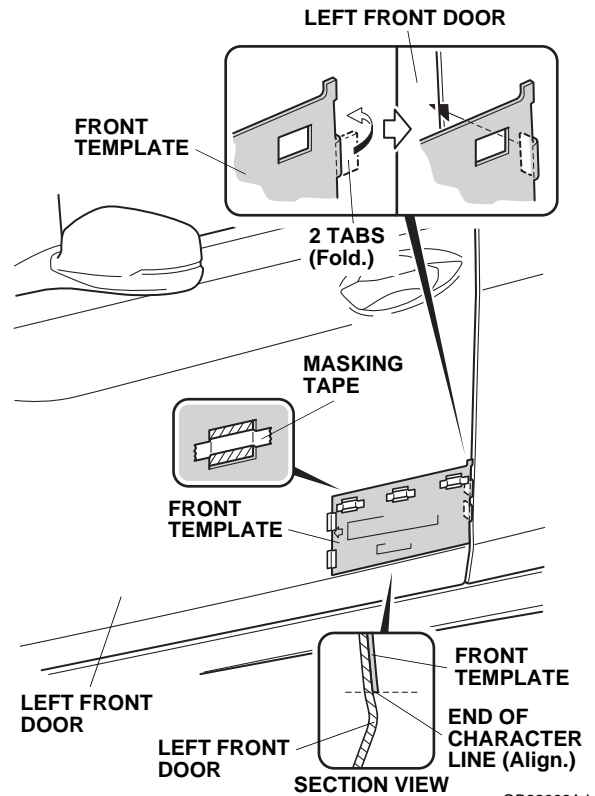

3. Align the front template with the end of the character line, and attach it to the left front door with strips of masking tape.

4. Peel back about 40 to 50 mm (1½ to 2 in.) of adhesive backing from each adhesive tape, and tape the ends to the front surface of the left front molding. Remove the other adhesive backings.

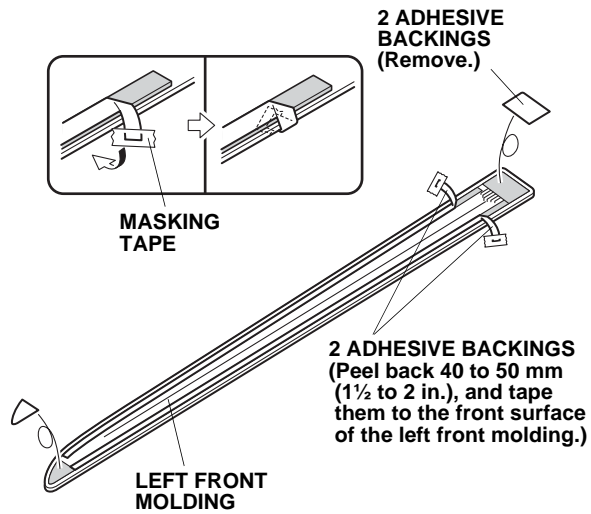

QB22004AJ

5. Align the left front molding with the front template and attach it to the left front door.

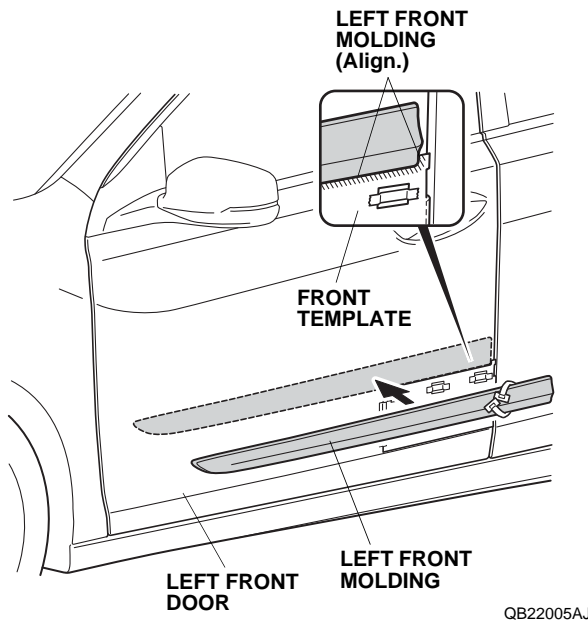

QB22005AJ

6. While applying light pressure against the left front molding, carefully remove the two adhesive backings.

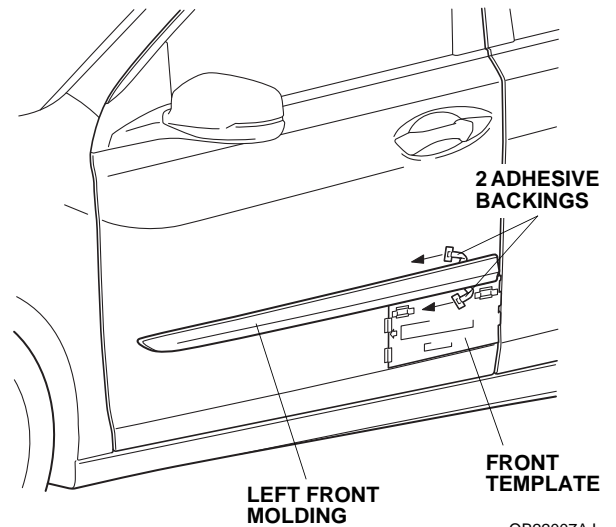

QB22007AJ

7. Using the palm of your hand, firmly press the left front molding to the left front door for 30 seconds.
8. Remove the front template.
9. Using a rubber roller, apply firm pressure while rolling to set the adhesive. Apply firm pressure especially at the ends.

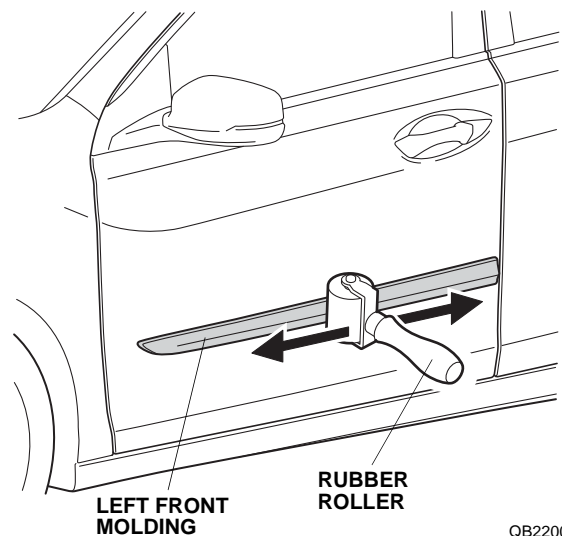

QB22008AJ

- Using the alcohol swab, thoroughly clean the rear door where the left rear molding will attach.

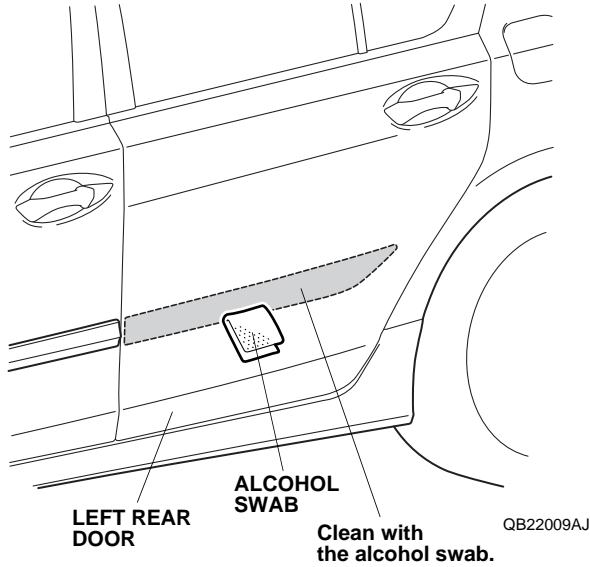

- Get the rear template. Fold the two tabs on the rear template in the direction shown, and insert them between the doors.

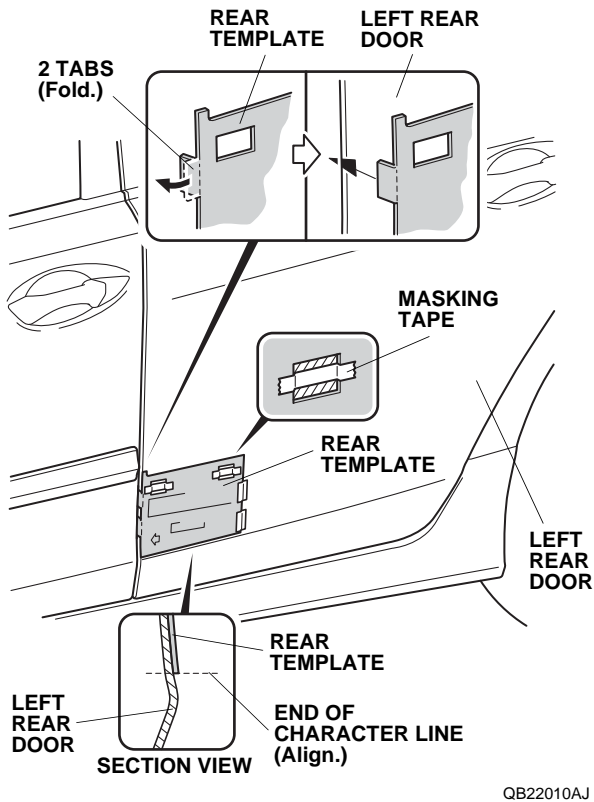

- Align the rear template with the end of the character line, and attach it to the left rear door using strips of masking tape.

- Peel back about 40 to 50 mm (1½ to 2 in.) of adhesive backing from each adhesive tape, and tape the ends to the front surface of the left rear molding. Remove the other adhesive backings.

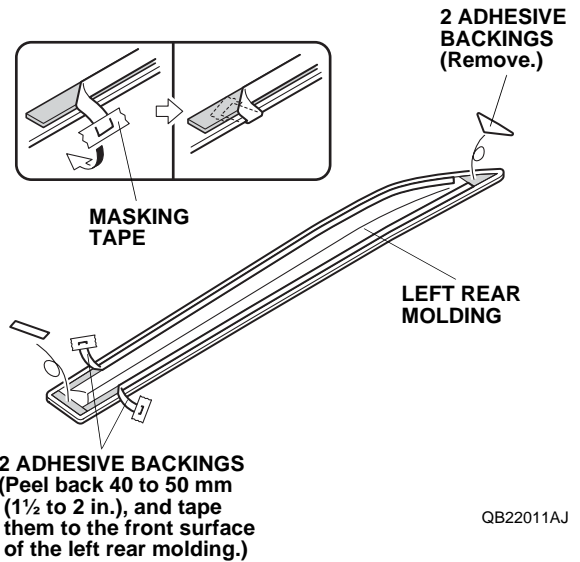

- Align the left rear molding with the rear template and the left front molding, and attach it to the left rear door.

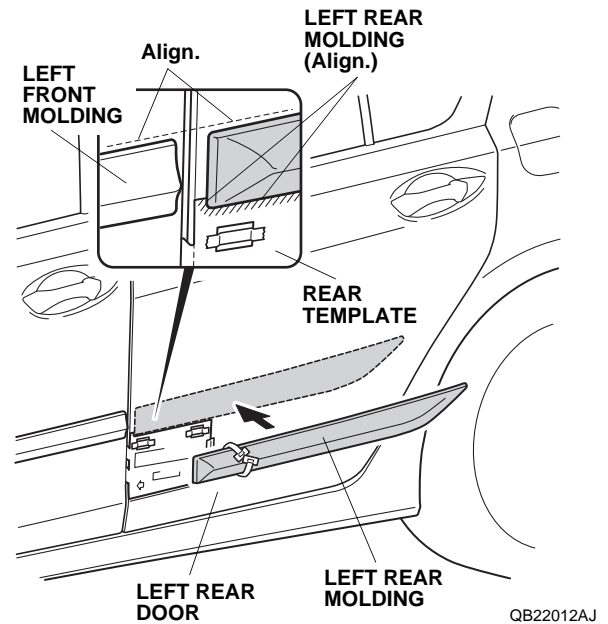

15. While applying light pressure against the left rear molding, carefully remove the two adhesive backings.

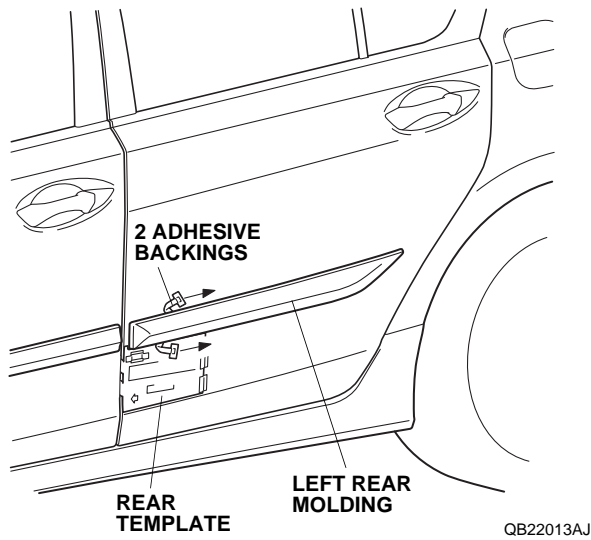

16. Using the palm of your hand, firmly press the left rear molding to the left rear door for 30 seconds.
17. Remove the rear template.
18. Using a rubber roller, apply firm pressure while rolling to set the adhesive. Apply firm pressure especially at the ends.

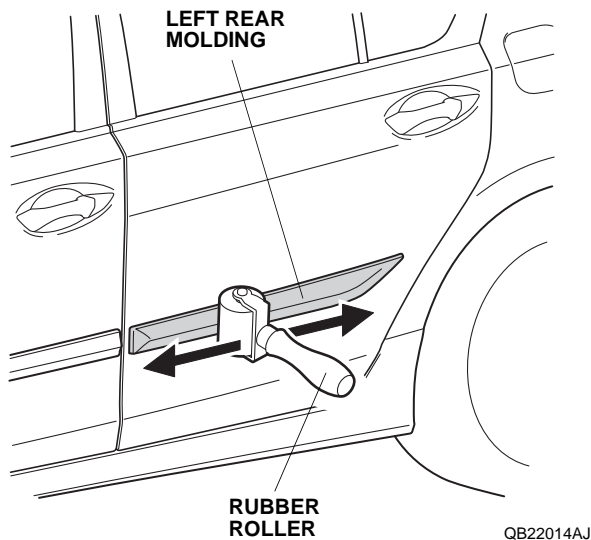

19. Turn the front and rear templates over, and repeat steps 1 through 18 to install the moldings on the right side of the vehicle.